

SPECIFICATIONS



EXTERNAL FACADE:

- Glazing in front elevation and textured paint in back elevation.

FLOORING:

- 32" X 32" Vitrified tiles flooring in Shops & Offices.
- Granite / Marble / Vitrified tiles in common areas.
- Granite / Paver blocks in ground level parking area.
- Rough Kota / Concrete Tremix flooring in Basement area.
- Granite jambs on doors & windows.
- Granite flooring on staircase.

WALLS & CEILING:

- Vitrified tiles cladding in common areas.
- Granite / marble cladding in lift lobby.
- Gypsum finish on walls in shops & Offices.
- Good quality POP false ceiling in common areas.
- Superior grade Putty finish ceiling in shops & Offices.

ELECTRICAL:

- Basic light points in all shops & offices. Provision of Air conditioning load upto distribution board.
- Basic Light & fan point power backup on Generator for Shops & Offices.
- Common area light & Elevator power backup on Generator.

ELEVATORS:

- Fully automated 8 passenger lift of Kone / Equivalent.

BATHROOMS:

- Attached bathroom in individual shops with designer ceramic tiles on floor and walls upto lintel level.
- Common bathrooms at each floor for offices and provision for supply & drainage for attached bathroom in individual offices.
- Sanitary ware of kohler / Equivalent.
- Bath fittings of Jaquar / Equivalent.

PARKING:

- Dedicated car and 2-wheeler parking for individual shops & offices.

SECURITY:

- 24 hours recording with high resolution night vision cameras for all common areas & Basement with 2 months backup capacity.



STRUCTURE

EARTHQUAKE RESISTANT R.C.C. FRAME STRUCTURE



ELECTRIFICATION

SUFFICIENT POWER SUPPLY AS PER REQUIREMENT



FLOORING

VITRIFIED FLOORING IN ALL SHOPS / OFFICES



PARKING

COMMON SUFFICIENT PARKING IN BASEMENT & GROUND FLOOR



TOILET

COMMON TOILET AT EACH FLOORS



PASSENGER ESCALATORS

GROUND, UPPER & 1st FLOOR GOOD QUALITY



SECURITY

CCTV CAMERA SYSTEM COMMON AREAS



GENERATOR

GENERATOR FOR COMMON AREA



FIRE SAFETY

FIRE SAFETY ACCORDING TO NBC NORMS



LIFTS

GOOD QUALITY AUTOMATIC 3 LIFTS IN BUILDING

Notes

- Legal/Document/Stamp Duty charges extra as applicable to be borne by members.
- Applicable government taxes including Service tax, VAT, etc. to be borne by members.
- Deposits for all services to be borne by members.
- Society maintenance charges to be borne by members.
- External and internal changes strictly not allowed.
- The brochure does not form part of an offer contract or agreement.
- All plans/drawings/features/specifications are subject to approval of respective authorities and may be changed if necessary. The discretion remains with developers.
- All rendering/floor plans/pictures and maps are artists' conception and not actual depiction of building.



Architect
 Saijay Joshi

Structural Engineer
Er. Jazil Sheikh
Ph. (0261) 247 2285, 247 2299

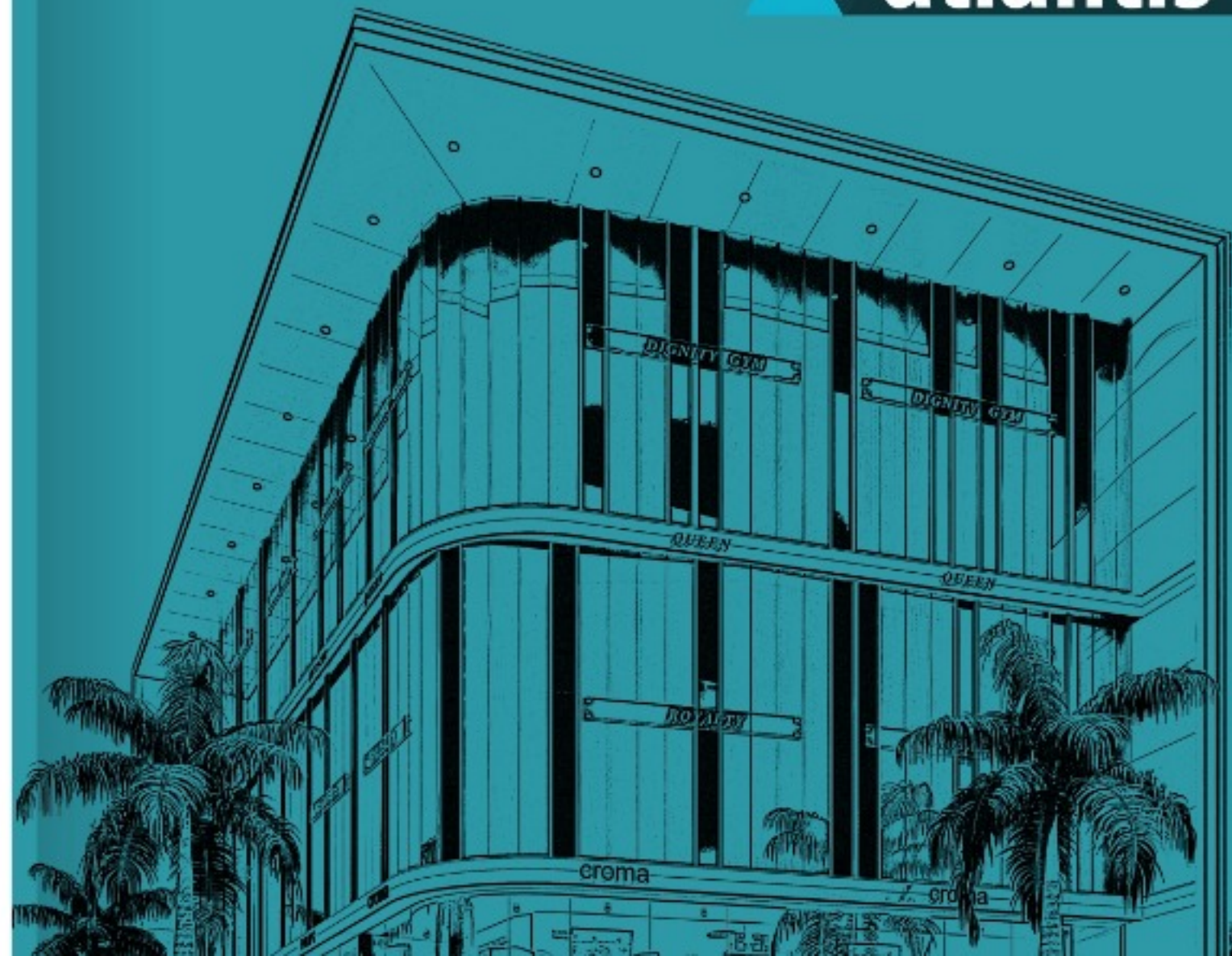



Established in 1968 by visionaries Mr. Satish Shah & Mr. Raju Shah "Milestone Group" is a name to reckon with in the field of realty development in the dazzling city of Surat. At Milestone Group, we believe that buildings should stand the test of times in terms of quality. We ensure this by using building materials of the highest quality, and hiring excellent craftsmen to build them. Our design philosophy is driven by simplicity of form, and functionality for its users; resulting in projects designed not for the bottom line, but as spaces for families to grow, and businesses to flourish. We believe that customers must have a stress-free experience during and after the sales process. With this belief, we have conducted our business in a fair and transparent manner for more than 40 years, which is a testament in itself.

PAST PROMINENT PROJECTS

Over The Last Four Decades We Have Initiated Landmark Projects Which Have Revamped The Infrastructural Map Of Surat. Our Archive Of Developments Includes High-rise Residential Complexes, Corporate Houses, Shopping Arcades, Bungalows, Row Houses Et Al. These Remarkable Creations Are Indeed Some Of The Path Breaking Milestones Achieved By The Milestone Group!! Our Pride Is Reflected In Satisfied Clientele Who Possess These Significant Spaces...

Milestone Leone	Athwagate - Commercial Project
Milestone Milagro	Vesu - Commercial Project
Milestone Habitat	Kailashnagar - Residential Low Rise
Milestone Ananta	City Light - Residential Low Rise
Milestone Vivanta Farms	Surat-naysari Rd. - Farm Houses Past Pro.

ONGOING PROJECTS FUTURE OF SURAT!!

Milestone Group has an aggressive plan to expand and some of its ambitious projects include:

Milestone 7 Heaven,	Vesu - Residential High Rise
Milestone Aquaticca,	Dumas - Residential High Rise
Milestone Palacio,	City Light - Residential High Rise
Milestone Atlantis,	Vesu - Commercial Project
Milestone Elements,	Piplod, Commercial Project
Milestone Vibrant,	Udana Darwaja, Commercial Project
Milestone Eternis,	Athwagate, Commercial Project
Milestone Sumeru,	Vesu, Residency



a building that has an envious LOCATION

- Give your business excellent visibility on one of **Surat's busiest roads**
- Milestone Atlantis is located on **BRTS road** and close to upcoming **Surat Diamond Bourse**

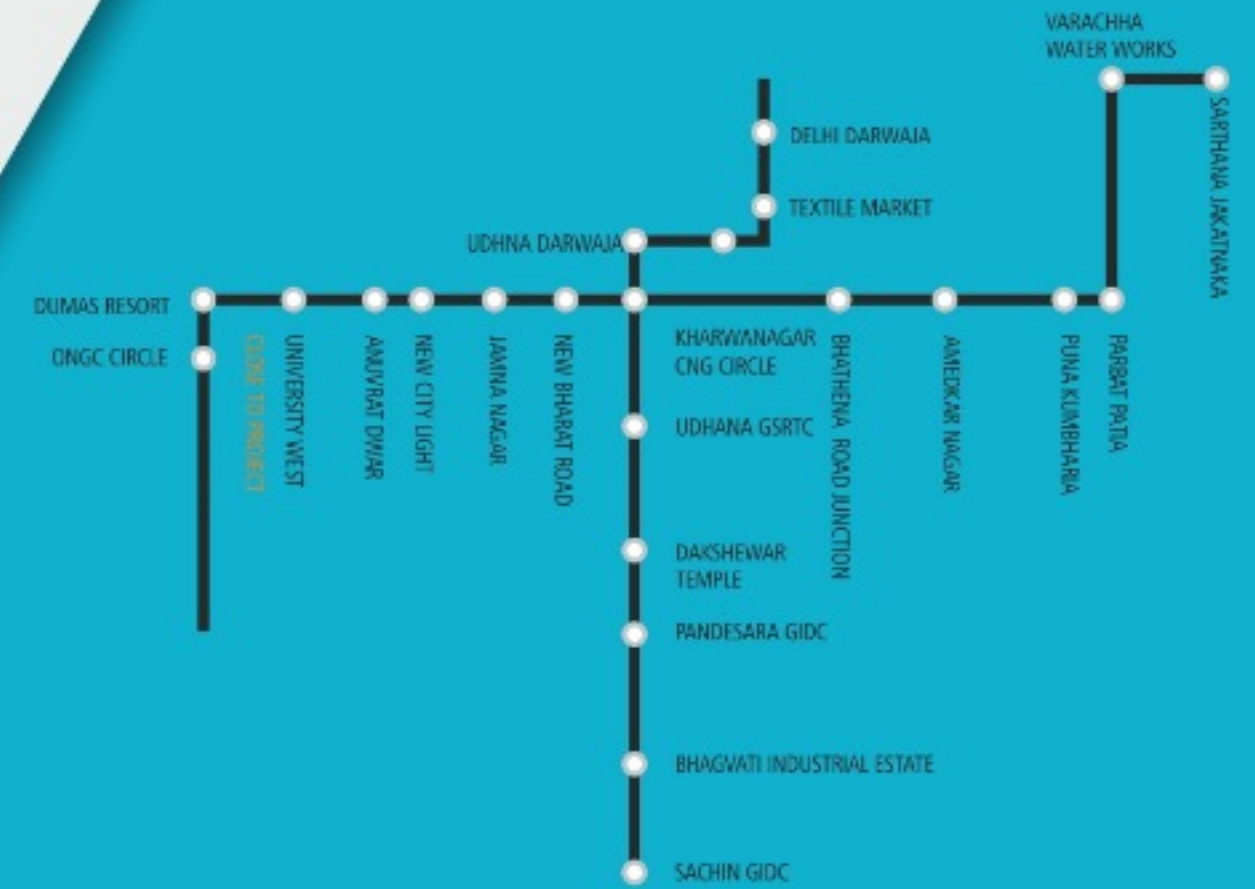



SHOWROOMS, AUTOMOBILES,
RETAIL, HEALTHCARE AND
OFFICE SPACES

Be a part of Surat's Automobile, Healthcare, Retail and
Entertainment Hub

Let your business look gorgeous with
13 ft height on Ground Floor and **10 ft height** in Offices

GROUND FLOOR PLAN 



1st FLOOR PLAN 

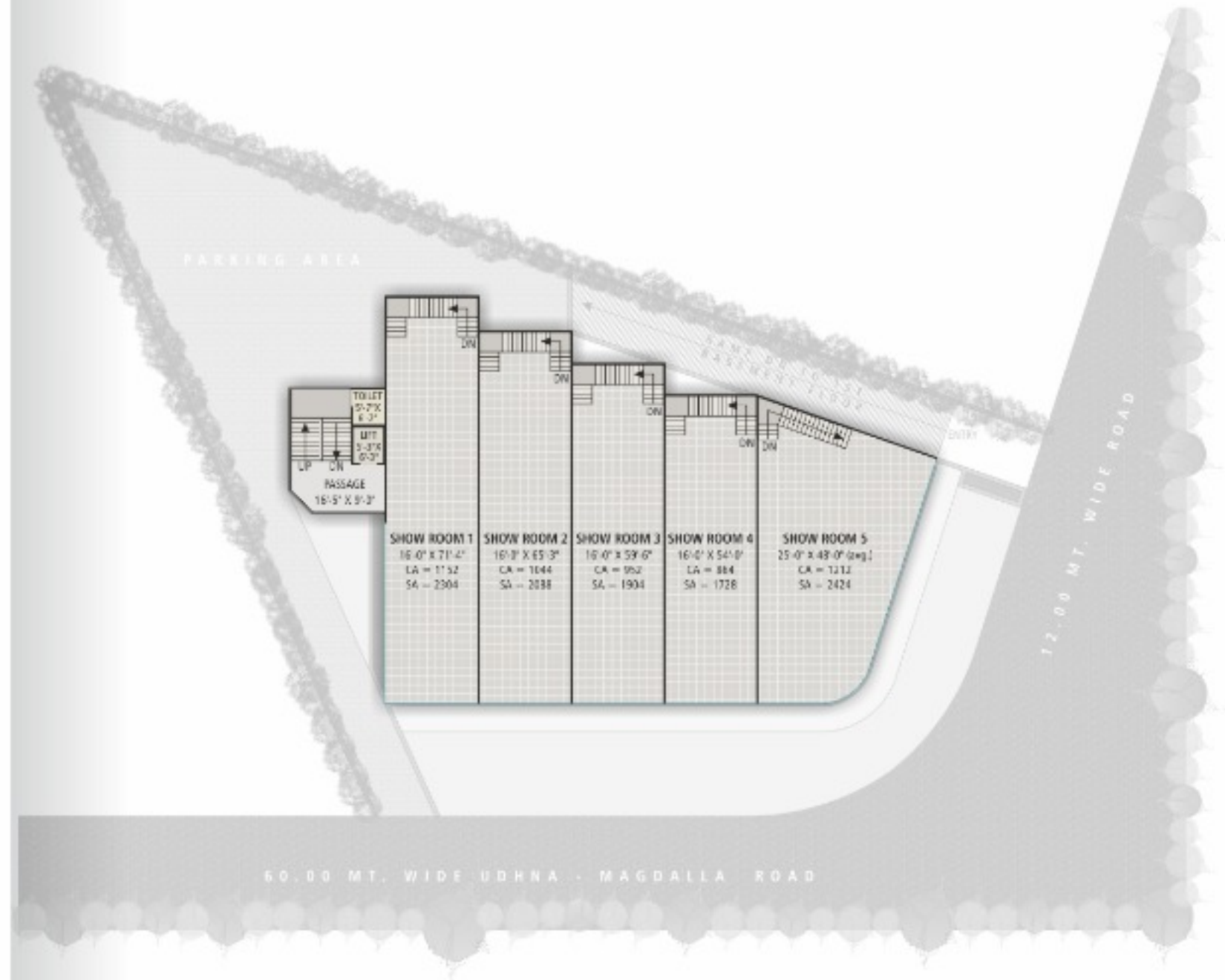

2nd to 4th FLOOR PLAN

