



Dumas Road, Piplod, Surat

Our Retailers



Our Retailers



Overview

RAHULRAJ MALL IS A WORLD CLASS SHOPPING & ENTERTAINMENT DESTINATION IN SURAT, DEVELOPED BY RAHULRAJ ESTATES PVT. LTD.



RAHULRAJ MALL IS LOCATED ON GAURAV PATH SURROUNDED WITH BEST OF HOTELS, PREMIUM RESIDENCY AND BUSINESS CENTERS OF MULTI-NATIONAL COMPANIES AND IS WELL CONNECTED WITH EVERY PARTS OF SURAT CITY.



RAHULRAJ MALL IS BEING POSITIONED AS A RETAIL DESTINATION WITH AROUND 4 LAC SQ FT OF RETAIL SPACE + 0.6 LAC SQ FT OF MULTIPLEX, THUS AIMING FOR ULTIMATE SHOPPING & ENTERTAINMENT.



RAHULRAJ MALL, ENJOYS FRONTAGE OF AROUND 300 FEET ON GAURAV PATH & 700 FEET ON OFF-DUMAS ROAD, IS FAIRLY RECTANGULAR IN SHAPE WITH REGULAR EDGES.



RAHULRAJ MALL ENJOYS EXCELLENT LOCATION AND GOOD CONNECTIVITY WITH INTERNATIONAL AIRPORT (3 KM), EXISTING BUS & RAILWAY STATIONS (10KM) AND DUMAS BEACH (7 KM).

Features



LARGEST RETAIL WITH MULTIPLEX DESTINATION IN SURAT.



4,00,000 SQ FT OF SHOPPING, DINING AND ENTERTAINMENT FOR ENTIRE FAMILY & FRIENDS.



PER FLOOR 1,00,000 SQ FT OF RETAIL SPACE, SPREAD OVER 4 FLOORS.



LIFESTYLE WITH GROUND + 2 LEVELS FOR WORLD-CLASS SHOPPING EXPERIENCES
8 SCREENS MULTIPLEX WITH PVR FOR WORLD CLASS EXPERIENCE OF MOVIES &
FAST-FOOD.



25,000 SQ FT OF ATRIUM FOR ETHNIC EVENTS & PROMOTIONAL ACTIVITIES.



20,000+ SQ FT OF PURE VEG DINING & FOOD COURT WITH EXCELLENT SEAT-OUT .



EXCITING GAMING FOR KIDS & YOUTH WITH WELL-KNOWN FAMILY ENTERTAINMENT
CENTRE.



1,50,000 SQ FT OF PARKING SPACES FOR OVER 700 CARS & 1000 TWO WHEELERS.

Specifics



THE PROPERTY IS DEVELOPED BY RAHULRAJ ESTATES PVT LTD, HEADED BY MR. RAJ SHAH (DIRECTOR-BUSINESS INNOVATION), A LEADING REAL ESTATE DEVELOPER HAVING REMARKABLE PRESENCE IN MUMBAI, PUNE & SOUTH GUJARAT.



THE PLANNING AND CONSTRUCTION OF THE BUILDING SHALL ADHERE TO THE NATIONAL BUILDING CODE (NBC) AND ALL APPLICABLE STATE AND LOCAL LEVEL BYELAWS/ REGULATIONS.



THE STRUCTURE DESIGNER OF RAHULRAJ MALL IS MR. JALILKUMAR SHAIKH, A LEADING NAME IN SURAT.



THE ARCHITECT FOR RAHULRAJ MALL IS 'SANJAY JOSHI & ASSOCIATES', WELL-KNOWN TEAM IN SURAT.

Catchment Profile



THE CATCHMENT IS MARKED BY RESIDENCY OF DIAMOND, TEXTILE BUSINESSMEN & SENIOR PROFESSIONALS WITH HIGHEST TURNOVER AND CONSISTS OF LARGE FLOATING POPULATION COMING TO GAURAV PATH FOR SHOPPING, DINING & ENTERTAINMENT.



THE CATCHMENTS' REQUIREMENT IS COMPETITIVE LUXURY RETAIL ENVIRONMENT WITH WORLD-CLASS AMENITIES FOR NATIONAL & INTERNATIONAL BRANDS TO REVOLUTIONIZE TRADITIONAL BUYING BEHAVIORS.



MANY LOCAL AND NATIONAL RETAILERS ARE SECURING HIGH STREET POSITIONS IN THE IMMEDIATE CATCHMENT OWING TO INCREASED ASPIRATION LEVELS OF THE POPULATION AND PENETRATION OF FORMAL RETAILING IN THE VICINITY OF GAURAV PATH.



THE MALL HAS A POTENTIAL CATCHMENT OF AROUND 10-12 LAC PEOPLE. THE RETAIL SPACE OF 4 LAC IS ABLE TO SUSTAIN IN THE DEFINED CATCHMENT.



THUS RAHULRAJ MALL IS ABLE TO SUFFICE THE CURRENT RETAIL DEMAND OF THE POPULATION AND WILL CAPITALIZE ON ITS WORTHINESS.

Interiors



Ground Floor

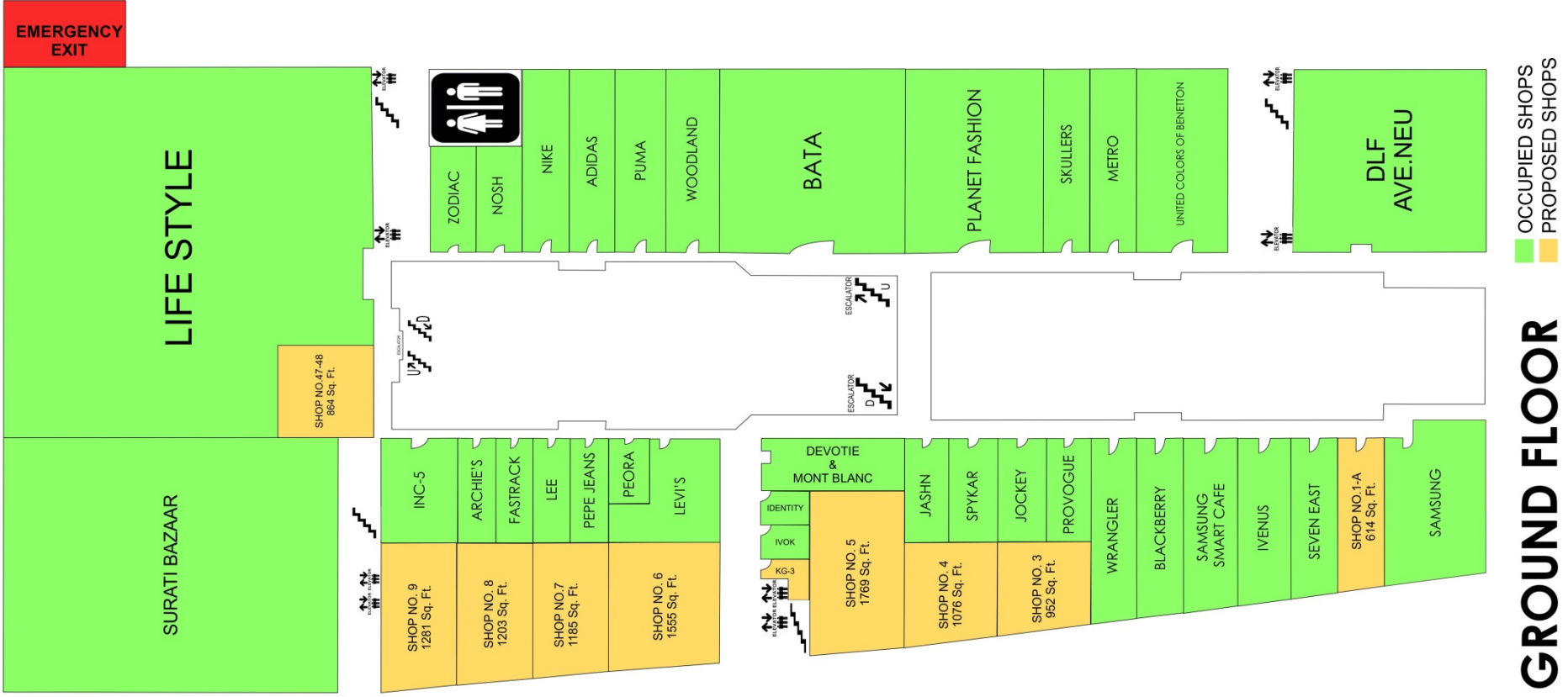

GROUND FLOOR

First Floor

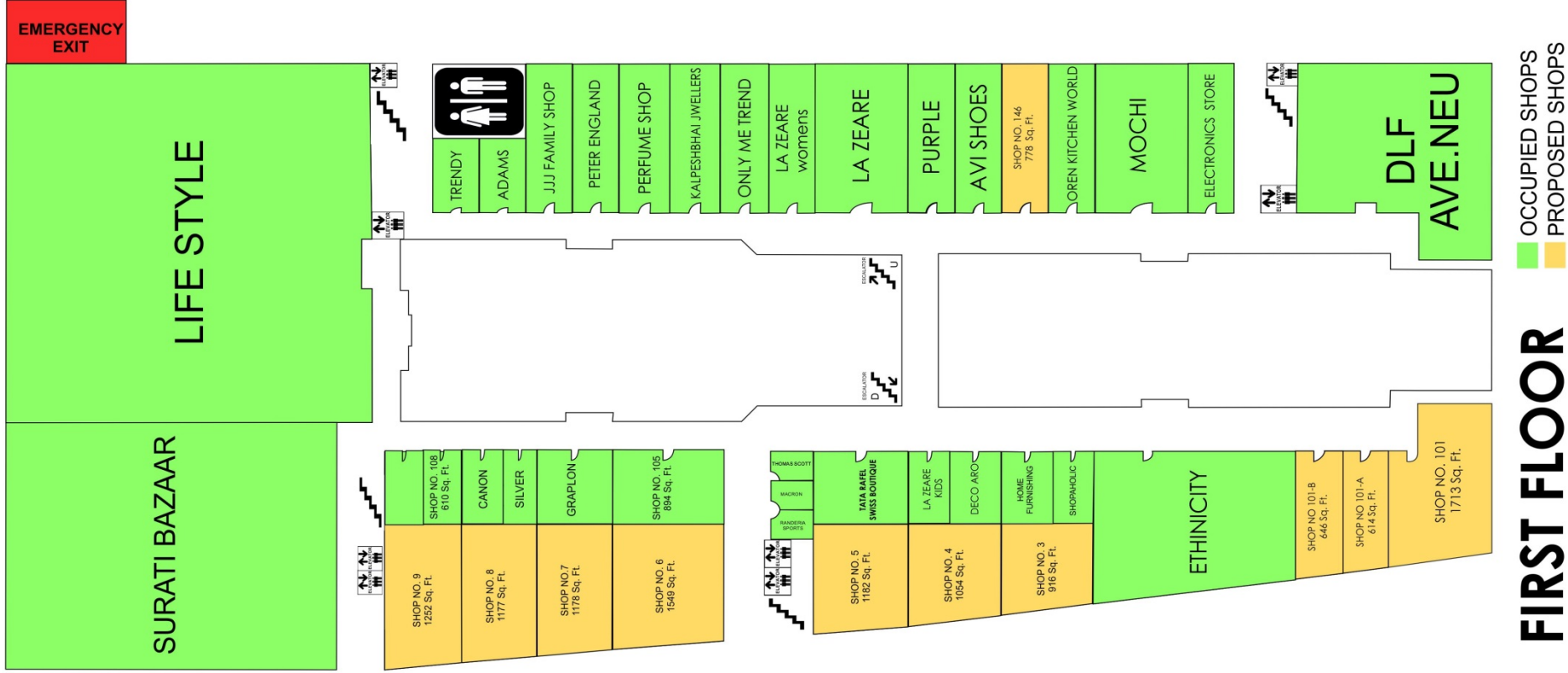

FIRST FLOOR

Second Floor

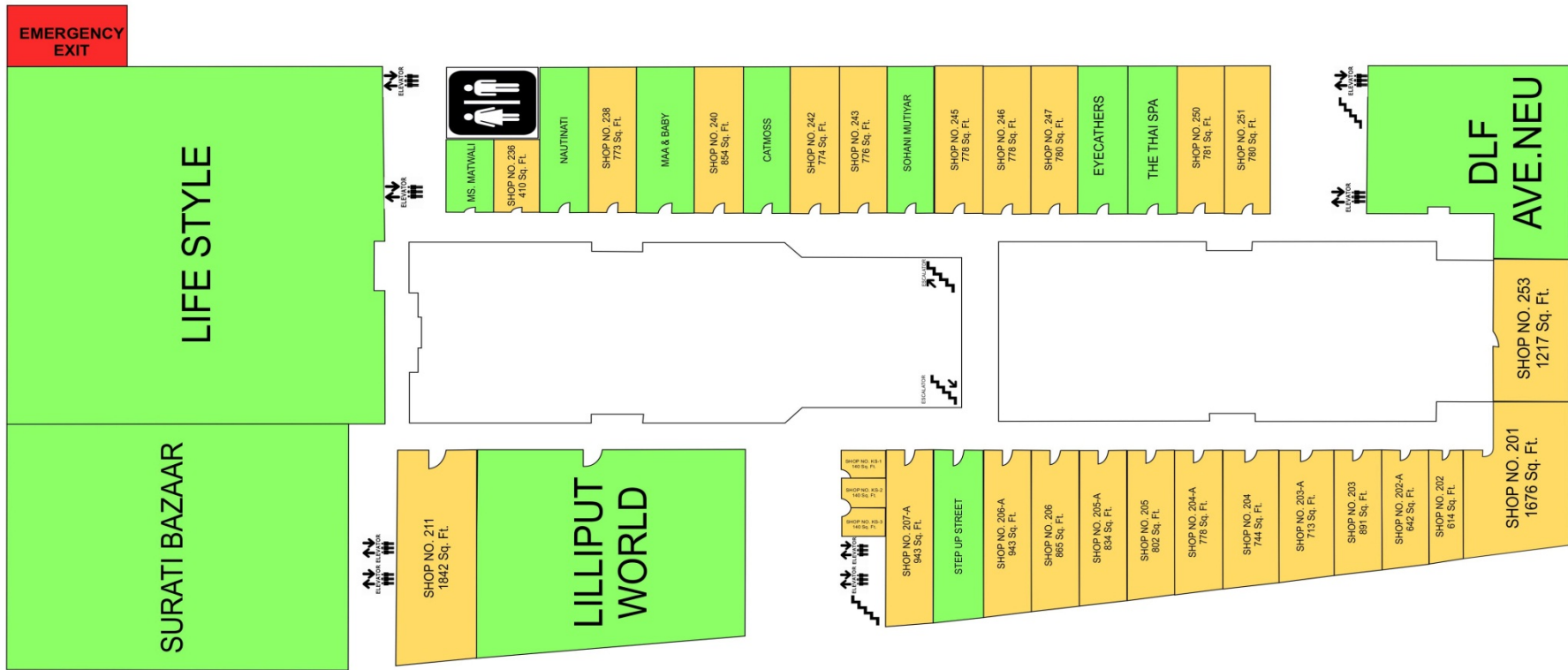

SECOND FLOOR

■ OCCUPIED SHOPS
 ■ PROPOSED SHOPS

Thanks & Regards



**RahulRaj
Mall**

mall.marketing@rahulraj.in