

# HTC-2

HINDUSTAN TEXTILE CENTRE



THE **BUSINESS** GATEWAY

HTC-2

HTC2

SACHI TEXTILES

RITU TEXTILES

ENTRANCE

ANIKTA TEXTILES

ANIKTA TEXTILES







**HTC-2**

HINDUSTAN TEXTILE CENTRE



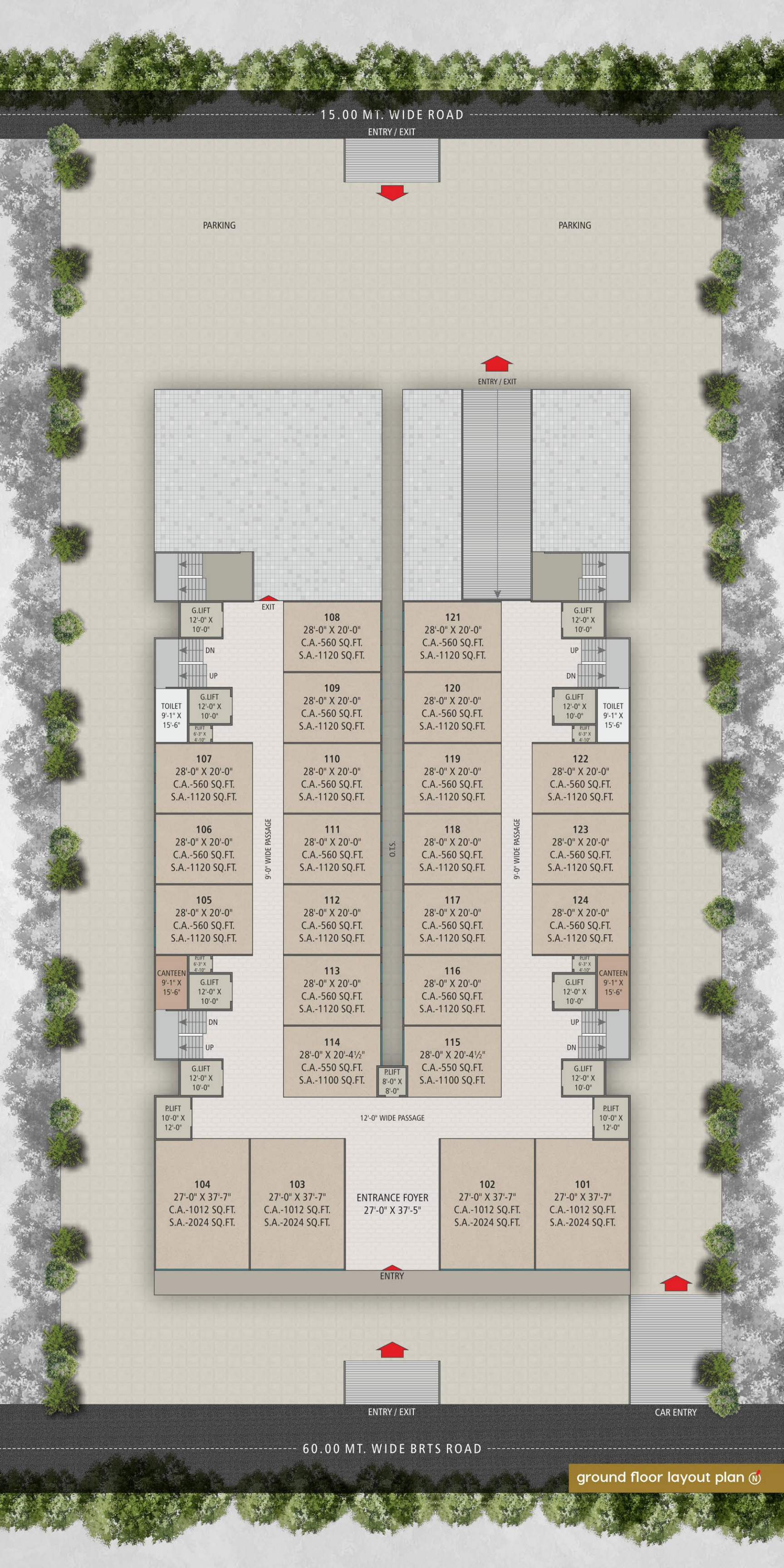

15.00 MT. WIDE ROAD

ENTRY / EXIT

PARKING

PARKING

ENTRY / EXIT

9'-0" WIDE PASSAGE

9'-0" WIDE PASSAGE

0.15

12'-0" WIDE PASSAGE

ENTRANCE FOYER  
27'-0" X 37'-5"

60.00 MT. WIDE BRTS ROAD

ENTRY / EXIT

CAR ENTRY

15.00 MT. WIDE ROAD

ENTRY / EXIT

PARKING

PARKING

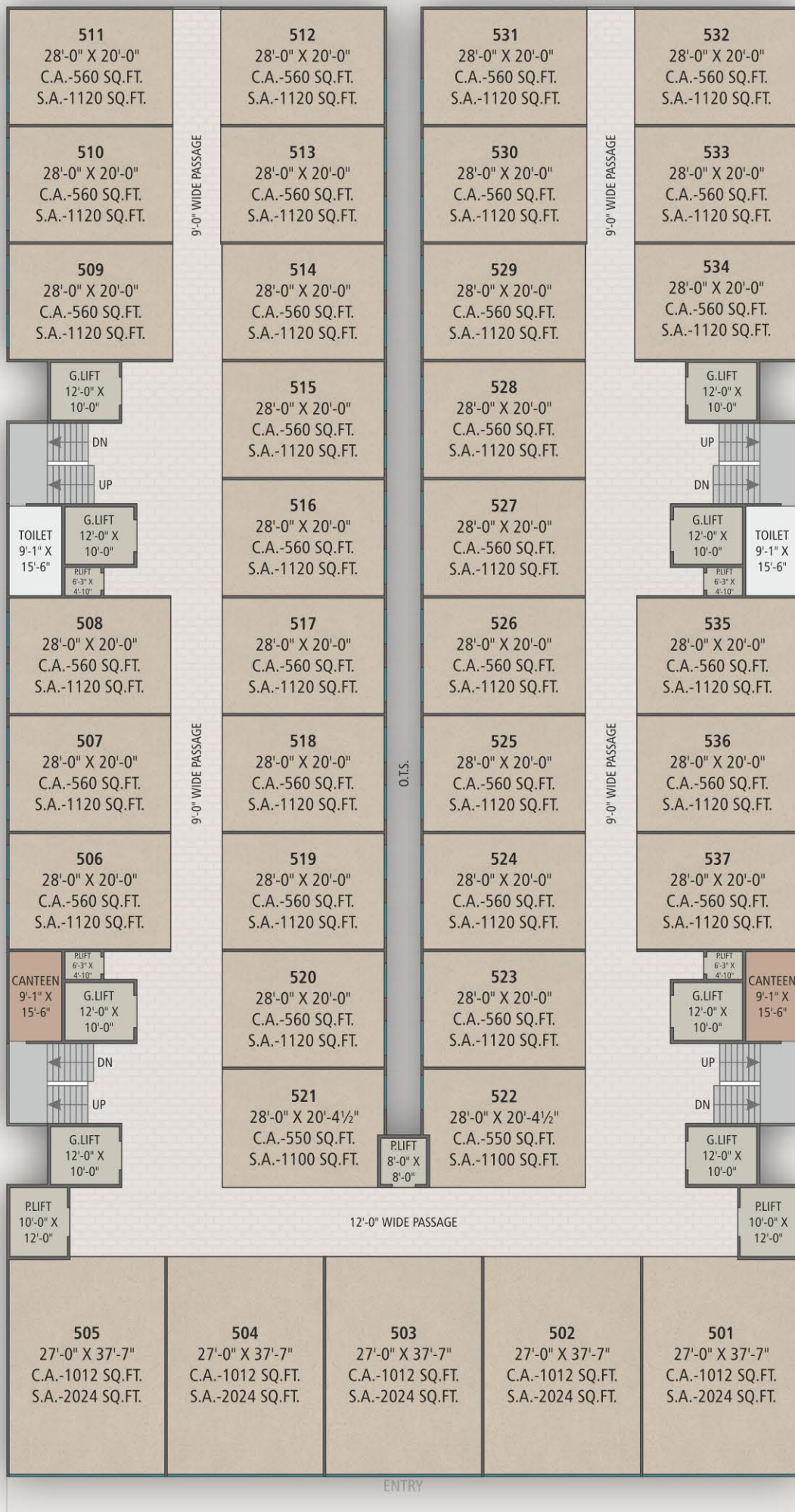

ENTRY / EXIT

CAR ENTRY

60.00 MT. WIDE BRTS ROAD

# HTC-2

HINDUSTAN TEXTILE CENTRE

Fancy Sarees | Dress, Garments | Lace Market |  
Big Centre of Online Traders

## Key Features

- Best in class 17 ft. height on each floor.
- Strategically located in the textile area at a distance of 400 mtr. from Millennium - 2 textile market & HTC market.
- Only 10 to 15 min distance from Bhatar Road, City Light, Vesu parle Point & Adajan.
- 2 way entry / exit with direct access on two roads of 200 feet and 50 feet.
- Sufficient high speed big size 10 goods and & 6 passengers lift.
- Parking space at ground level and two level basement with 17 feet height at each level.
- Sufficient power connection from torrent power.
- Elevation with designer lighting, along with natural light and air ventilation.



# Specification

## Showroom / Shop Specification

### ■ Floor Finish

- Standard quality vitrified tiles in showrooms / shops.

### ■ Electrical

- Modular switches, wiring, MCB and sufficient electric points.
- Sufficient concealed wiring with standard accessories.
- T.V. & telephone point.

### ■ Shutter

- Powder coated aluminum shutter.

### ■ Wall Finish

- Internal white putti on all plastered walls and ceiling.

### ■ Plaster

- External plaster double coat.
- Internal single coat plaster.

### ■ Elevation

- Aluminum composite panel & toughen glass in front part.
- Elegant external facade.

### ■ Lift Cladding

- Granite cladding in each floor near passenger lift entrance and goods lift entrance.

### ■ Entrance Foyer

- Foyer with well designed Italian flooring and cladding.

## Building Specification

### ■ No. of floors

- Two level basement + ground floor & upper ground floor + 1st to 8th floor.

### ■ Passage

- Granite or equivalent good quality tiles in floor.

### ■ Common Toilet

- Decorative dado tiles with standard quality
- Sanitary wares & C.P. fittings of CERA, Hindware, Jaguar or equivalent make.

### ■ Lift

- Fully automatic passenger lift and sufficient capacity goods lift.

### ■ Fire Safety

- All passages installed with smoke detectors, fire alarm, water hydrant, fire extinguisher and sprinklers.

### ■ Security

- CCTV camera coverage in campus, basement and all common areas.

### ■ Parking

- Two level parking in basement and parking on ground floor.
- Ground floor parking finished with good quality paver blocks / tri-mix.
- Basement parking finished with V.D.S. (tri-mix rough finish)

## Technical Specification

### ■ Building Structure

- Earthquake resistant design as per IS codes for RCC frame structure.

## NOTE

- All rights for alteration / modification and development in design or specifications by architects and / or developer shall be binding to all the members.
- BUC (Building Use Certificate) as per SMC / SUDA rules, clear titles for loan purpose.
- This brochure is for private circulation only. By no means, it will form part of any legal contract.
- Stamp duty, Registration fee, Power charges, GST & any other government taxes will be borne by the purchaser.

\* All furniture / objects shown in the plan are for presentation & understanding purpose only. By no means, it will form a part of final deliverable products.

# All the elements, objects, treatments, materials, equipments & colour scheme shown are artisan's impression and purely for presentation purpose. By no means, it will form a part of the amenities, features or specifications of our final products.





## Location map

A PROJECT BY

**HTC-2**  
GROUP

Address:

HTC-2, Hindustan Textile Centre, Nr. Samrat School,  
Opp. BRTS Bus Stop, BRTS canal road, Dumbhal, Surat.

Contact: +91 98251 25127

RERA No.: PR/GJ/SURAT/SURAT CITY/SUDA/CAA04724/220119

website: [www.gujrera.gujarat.gov.in](http://www.gujrera.gujarat.gov.in)

MEMBER OF  
**CREDAI**

## CONNECTIVITY

Domestic Airport	: 15.0 k.m.
Railway Station	: 03.0 k.m.
Proposed Metro Station	: 00.2 k.m.
Police Station	: 00.1 k.m.
Petrol Pump	: 01.5 k.m.
Hotel	: 02.0 k.m.
School / Collage	: 00.2 k.m.
Highway Connection	: 03.0 k.m.

Millennium-2 Textile Market **400 mtr.** only  
HTC Textile Market **400 mtr.** only